



- Modular system consisting of plastic housing with plastic or metal protection in several colors.
- Protection degree IP67
- Different contact blocks.
- Different activation devices.
- The unit is operated through a non-skid pedal.
- An oil and chemical-resistant rubber membrane protects safely against dust and humidity (protection degree IP67).
- Stroke limitation avoids mechanical overloading.
- Plastic pedal switches, modular contact blocks inside allow various contact possibilities.
- 46 Series foot switches may also be mounted with Top or Complete protection against unintentional actuation.

### ***Follow These Few Steps:-***



- 1. Take a micro switch that is no longer functioning.**

- 2. Remove the TOP SCREW using suitable screwdriver (manual or powered)**





3. Remove the TOP COVER

4. Micro Switch which is Not functioning

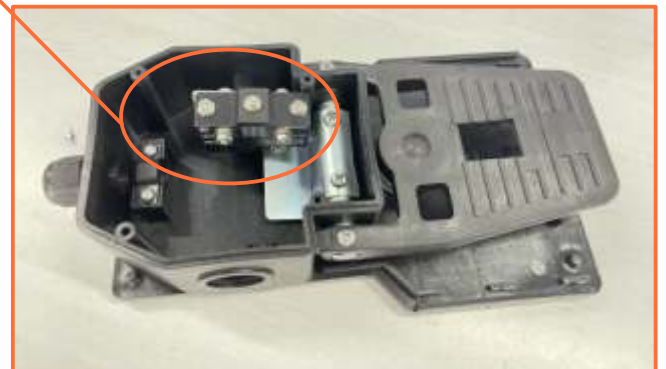

5. Undo the Nuts using spanner size no. 7 as shown in image



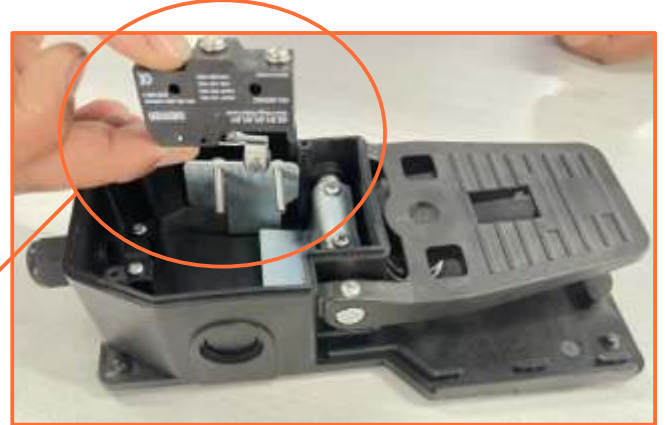
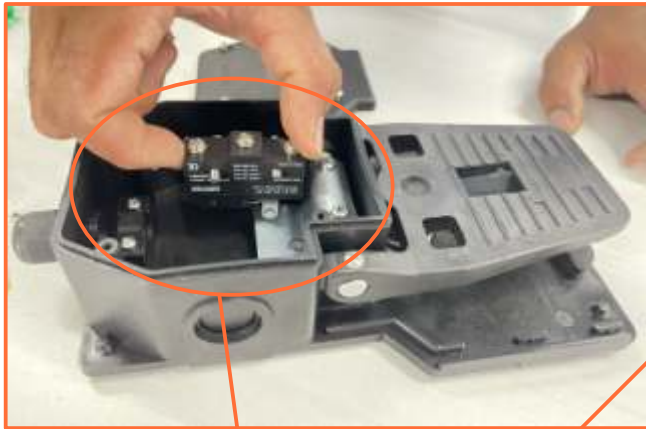

**6. Remove the Micro Switch**



**7. Insert the new Micro Switch**

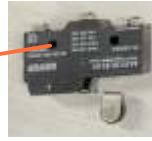
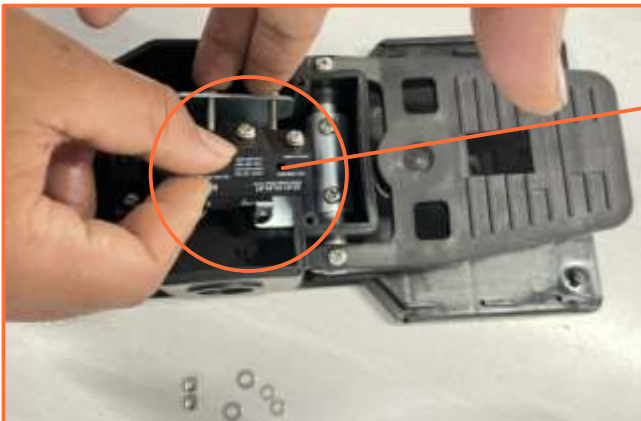

Properly insert the bolt into Micro switch hole

8. As shown in the image, hold the bolts properly and insert the Micro Switch.

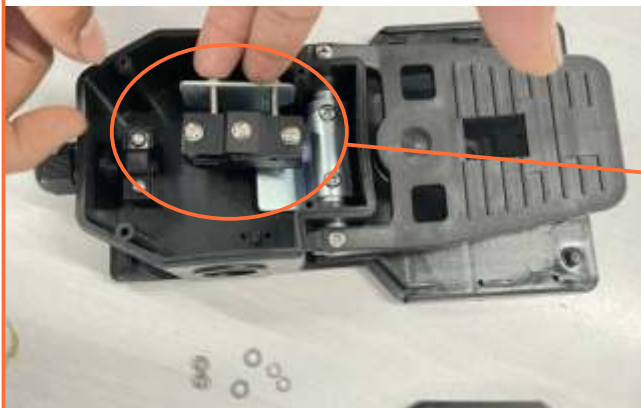

Its has to be inserted as shown in image



9. A. As shown in the image, hold the bolts properly and inserting the Micro Switch first, followed by the Flat washer.



9. B. As shown in the image, hold the bolts properly and inserting Flat washer, followed by Cut washer.





10. Then insert nuts to fix the micro switch

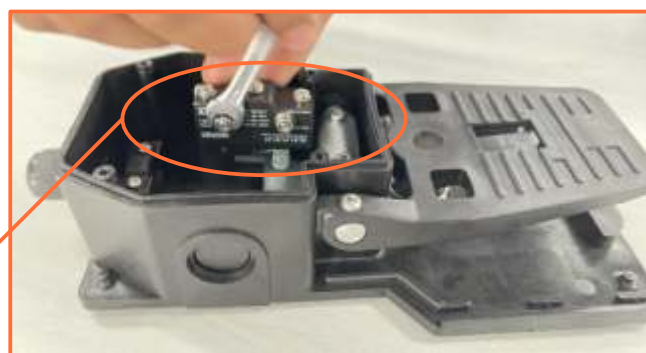

11. As shown in the image, tighten nuts using spanner



12. New Micro switch replaced

**Note: While inserting Micro Switch don't remove the metal plate or loosen the metal plate screw**

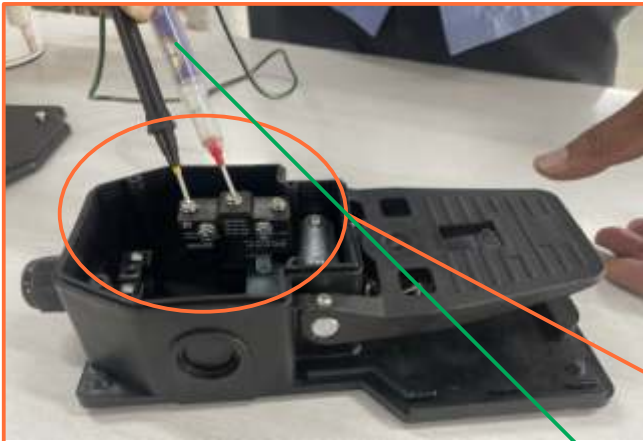

13. Use a continuity tester to check the NO and NC connective after inserting the micro switch

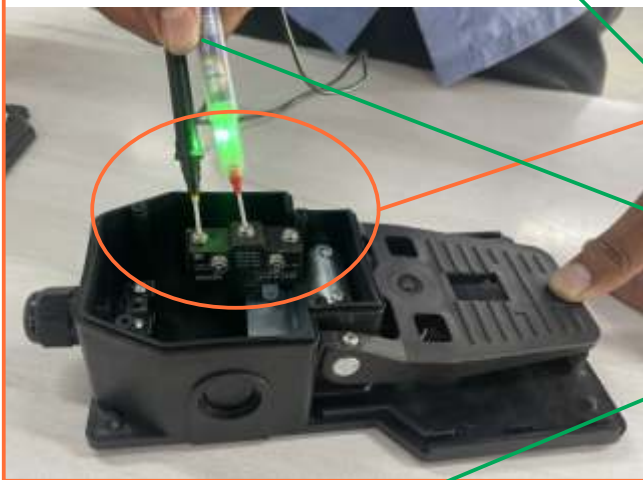

'NO' testing



Continuity tester

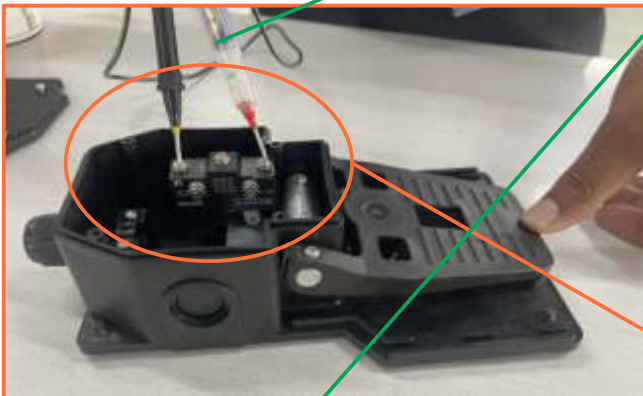

Test the Micro Switch by pressing the foot paddle

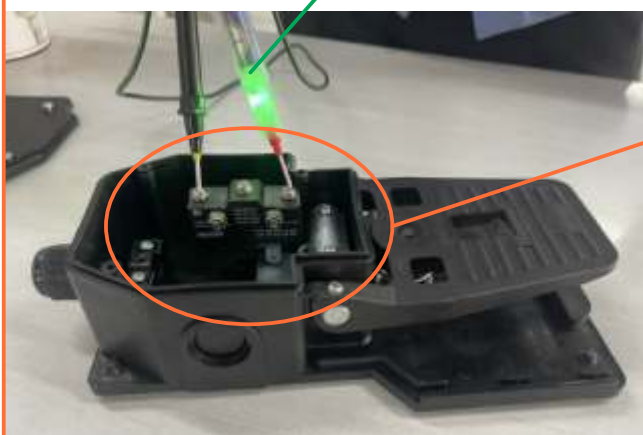

'NC' testing

**Note: If Connective fails, recheck the TESTER or Micro Switch**

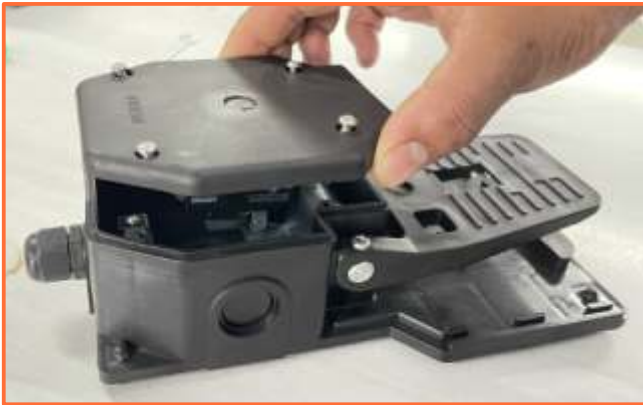

14. After testing Micro Switch, close the Top Cover of foot Switch

15. Tighten top cover screw using suitable screwdriver (manual or powered)



Ready to use it