

WERNER

Inventing Innovation...

Living Industrial Partnerships

PRODUCT SPECIFICATION

93 Series Modular Control Station



www.wernerelektrik.com

Features

- Fully Modular Control Station.
- Protection Degree: IP65.
- Provides Housing for Multiple Pushbuttons, Pilot Lights & Other Components
- Completely Customizable.
- Easy Assembly.
- Various Colours & Engraving Option.
- Operating Temperature - 25° C to 70°C.

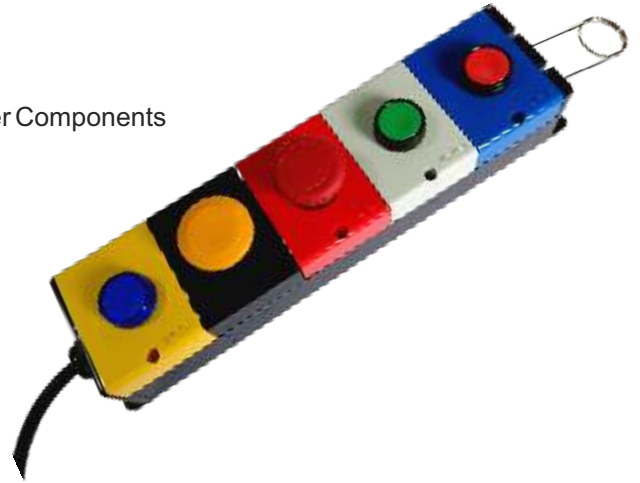

Specification

Number of vertical rows	1
Product weight	0.165 kg
Resistance to high pressure washer	7000000 Pa at 55 °C, distance: 0.1 m
Mounting of block	Rear mounting & free hanging
Assembly style	Modular
Protective treatment	-20 ~ 55 °C
Ambient air temperature for storage	-40 ~ 70 °C
Ambient air temperature for operation	-25 ~ 70 °C
Class of protection against electric shock	Class II conforming to IEC 60536
NEMA degree of protection	NEMA 4X, NEMA 13
IK degree of protection	IK10 conforming to EN 50102
Standards	CSA C22-2 No 14, EN/IEC 60947-1, EN/IEC 60947-5-1, EN/IEC 60947-5-4, EN/IEC 60947-5-5, JIS C 4520 & UL 508
Colours of Cover	Yellow RAL1023, Black RAL9017, Red RAL3020, Grey RAL7035, Blue RAL 5017
Colour of Base	Black RAL 9017
Material	ABS
Cable entry	1 knock-outs for Pg 13.5 cable gland and ISO M20, Clamping capacity: <= 12 mm
IP degree of protection	IP67 IP66 conforming to IEC 60529 IP69K IP69

ORDERING TABLE

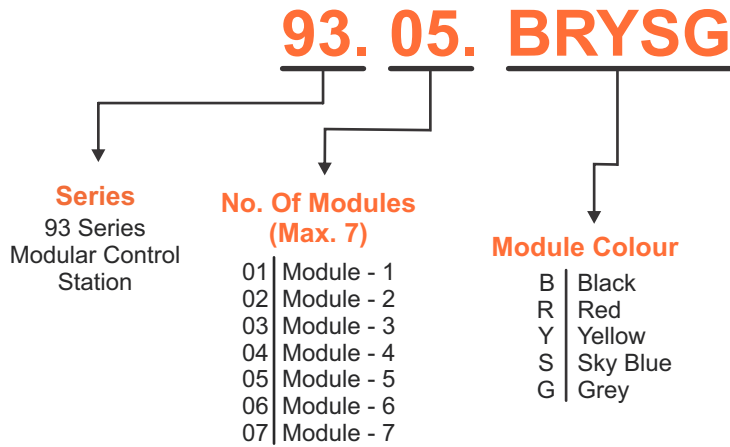

Ordering Sample



Ordering Code
93.02.YY

Series + Modules + + + +

93.02.Y Y

Top cover with Ø22mm Cutout	Module Code With Description	Top cover with Ø22mm Cutout	Module Code With Description
	93.B TOP COVER WITH BASE BLACK - RAL 9017		93.R TOP COVER WITH BASE COVER : RED - RAL 3020 BASE : BLACK - RAL 9017
	93.Y TOP COVER WITH BASE COVER : YELLOW - RAL 1023 BASE : BLACK - RAL 9017		93.S TOP COVER WITH BASE COVER : SKY BLUE - RAL 5017 BASE : BLACK - RAL 9017
	93.G TOP COVER WITH BASE COVER : GREY - RAL 7035 BASE : BLACK - RAL 9017		END PLATE SET BLACK - RAL 9017 (Common For All)

Accessories



Control Station fitted with

Flush pushbutton
Pilot light
Illuminated pushbutton
Projecting pushbutton
Selector switch
Mushroom head pushbutton
Latching mushroom head Emergency stop pushbutton with key
Key switch



CATALOGUE

Scan for the Switches and Indicators

Dimensions

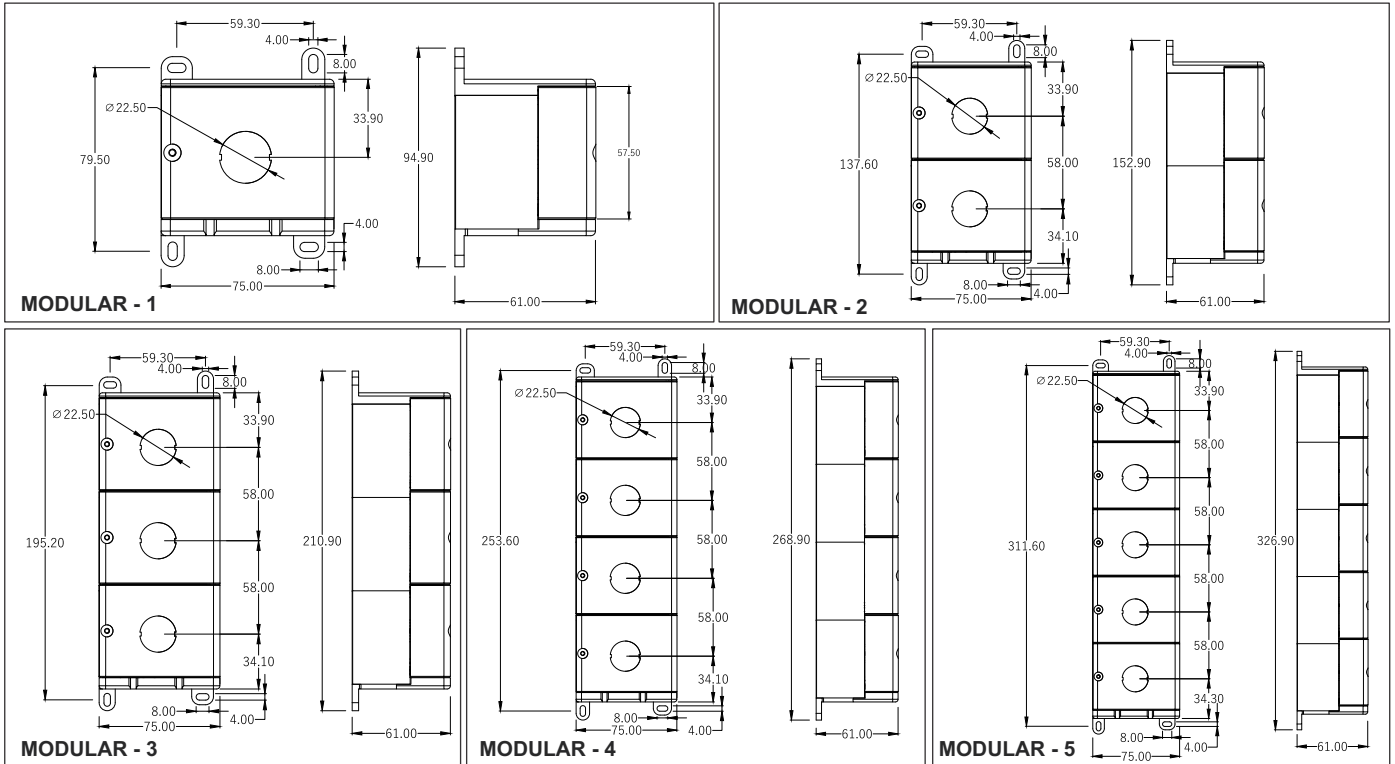

Exploded View

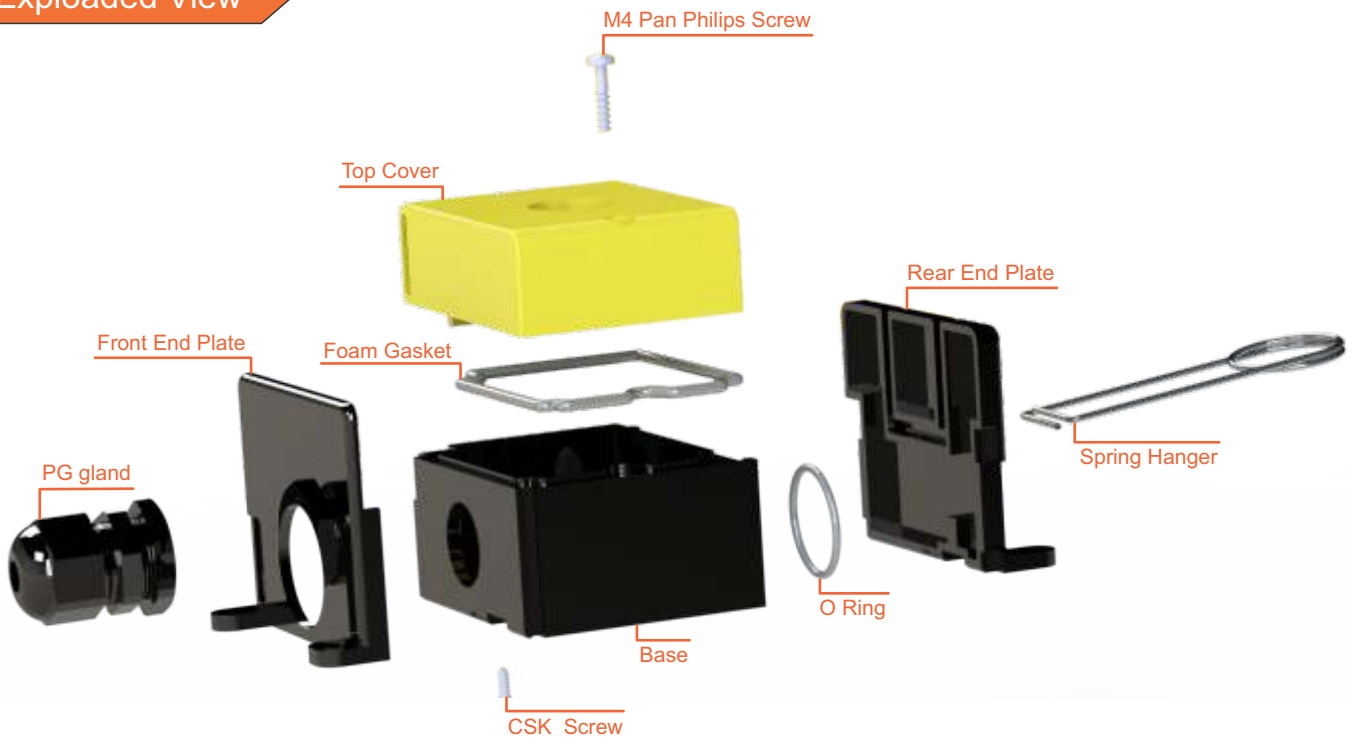

WERNER

Inventing Innovation...

H.Q.

Werner Electric Private Limited

Plat No.: 166, Hebbal Industrial Area, Mysore - 570016, India.
Tel: +91 73539 47299, E-mail: info@wernerelektrik.com

Werner Malaysia Sdn Bhd,

45-2, Jalan Tiara 2B, Bandar Baru Klang,
41150, Klang, Selangor, Malaysia.
Tel: +60 13 533 3348, E-mail: info@wernerelektrik.com

Werner Elektrik Türkiye

Ayazağa Mah. Mimar Sinan Sok. Seba Office Boulevard.
D Blok. No.: 21D/45 Sariyer / İstanbul, Türkiye.
Tekefon: +90 539 829 25 07 , E-posta: info@wernerelektrik.com

www.wernerelektrik.com